

Capital Committee Meeting Minutes

4/4/2014

Attendees: Ron Broas, Daren Lolkema, John Lumina, Jen Oppenheim, Maureen Primrose, John Sharkey, Marilyn Shultz, Antonietta St. George, Philip Zemke and Maryann Zimmerman

Rhinebeck Architecture – John Sharkey and Phil Zemke

- Design schedule is on time and on budget.
- Phase 1 has been approved by SED, the bid process will begin next week. Phase 2 is expected to be approved at the end of July 2014.
- Rhinebeck Architecture updated committee on project scopes and project schedules at each school site using a Power Point presentation (hand out attached)
- The Committee has requested Rhinebeck to write up a Press Release updating the district status of capital projects; committee suggested to include the SED timeline of approval for the district to understand the hold up of projects being started.
- A Pre-bid meeting is scheduled for April 17th at The Roy C. Ketcham Auditorium. Rhinebeck will review scopes with all interested contractors.
- The Bid openings are scheduled for April 30th at the Central Office.



Project Progress Report

- **Project Scope and Schedule**
 - **Facility Improvements**
 - **Transportation Facility**

2013 District Wide Renovations Progress Report

Wappingers Central School District

RHINEBECK ARCHITECTURE & PLANNING PC

April 3, 2014

1



Design Schedule

- **Phase 1 Projects**
 - **Submitted to NYSED 12/6/13**
 - **3 Month Review Period**
 - **Review anticipated early April 2014**
 - **Construction Bids End of April**

- **Phase 2 Projects**
 - **Submitted to NYSED 1/29/14**
 - **6 Month Review Period**
 - **Review anticipated late July 2014**
 - **Construction Bids End of August**

2013 District Wide Renovations Progress Report

Wappingers Central School District

RHINEBECK ARCHITECTURE & PLANNING PC

April 3, 2014

Roy C Ketcham High School



Scope and Schedule

Summer 2014

- 1. Replace Roof
- 2. Recoat Running Track
- 3. Replace Exterior Bleachers

School Year 2014-2015

- 4. Convert to Gas Heating Fuel
- 5. Security Improvements
- 6. Upgrade Emergency Lighting

Summer 2015

- 7. Replace Windows

2013 District Wide Renovations Progress Report

Wappingers Central School District
RHINEBECK ARCHITECTURE & PLANNING PC

April 3, 2014

3

John Jay Senior High School

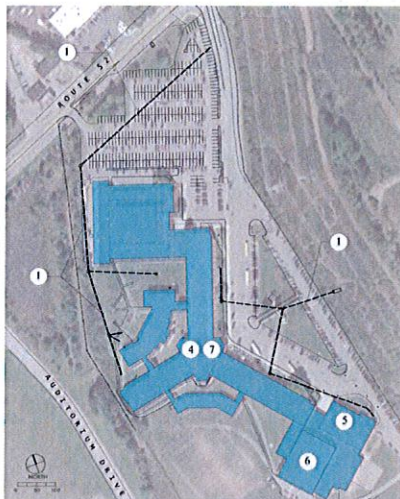

Scope and Schedule

Summer 2014

- 1. Storm Drainage Repairs
- 2. Replace Running Track
- 3. Replace Exterior Bleachers
- 6. Replace Gym Wall Pads

School Year 2014-2015

- 4. Upgrade Emergency Lighting
- 7. Security Improvements

Summer 2015

- 5. Replace Cafeteria Windows

2013 District Wide Renovations Progress Report

Wappingers Central School District
RHINEBECK ARCHITECTURE & PLANNING PC

April 3, 2014

4

John Jay Senior High School

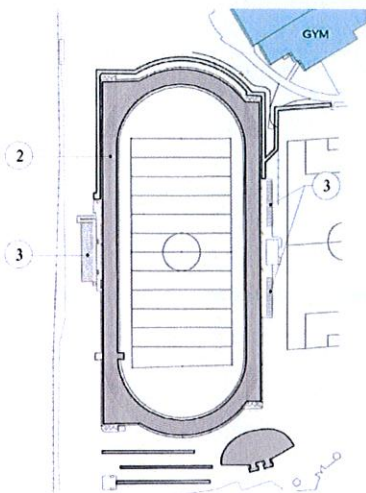

Scope and Schedule

Summer 2014

1. Storm Drainage Repairs
2. Replace Running Track
3. Replace Exterior Bleachers
6. Replace Gym Wall Pads

School Year 2014-2015

4. Upgrade Emergency Lighting
7. Security Improvements

Summer 2015

5. Replace Cafeteria Windows

2013 District Wide Renovations Progress Report

Wappingers Central School District

RHINEBECK ARCHITECTURE & PLANNING PC

April 3, 2014

5

Van Wyck Junior High School

Scope and Schedule

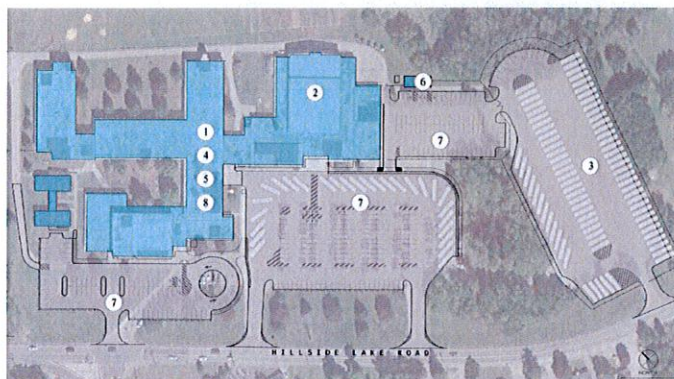

New Parking Statistics

Bus / Driver lot

80 buses

90 cars

School Parking Lots

27 buses (33± existing)

194 cars (173± existing)

6 drop off spaces (4± ex)

Summer 2014

1. Replace Roof
2. New Gym Bleachers and Gym Wall Pads

School Year 2014-2015

3. Bus Parking
4. Security Improvements
5. Upgrade Emergency Lighting
6. Bus Driver's Building

Summer 2015

7. Reconfigure Parking Areas
8. Replace Windows

2013 District Wide Renovations Progress Report

Wappingers Central School District

RHINEBECK ARCHITECTURE & PLANNING PC

April 3, 2014

6

Wappingers Junior High School Scope and Schedule

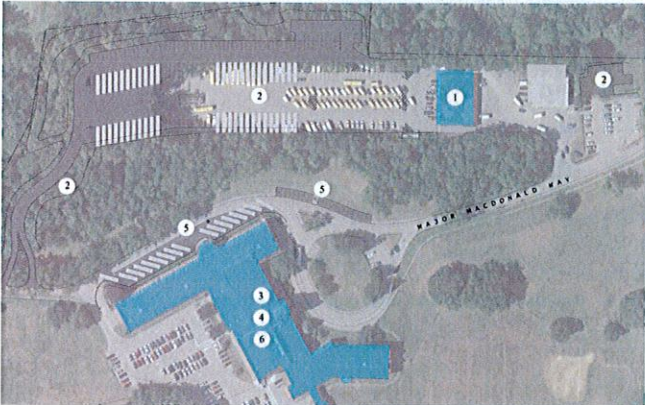

New Parking Statistics
 North Parking Lot
 32± existing + 19 new = 51±
 Main Parking Area
 50 buses (29± existing)
 80 vans (79± existing)
 130 cars (37± existing)
 Major Macdonald Way
 17 buses
 20 cars

Summer 2014	School Year 2014-2015	Summer 2015
1. Replace Roof at Bus Garage	2. Bus Parking	5. Replace Fire Alarm System
	3. Security Improvements	6. Reconfigure Parking Areas
	4. Upgrade Emergency Lighting	

2013 District Wide Renovations Progress Report

Wappingers Central School District

RHINEBECK ARCHITECTURE & PLANNING PC

April 3, 2014

7

Brinckerhoff Elementary School Scope and Schedule

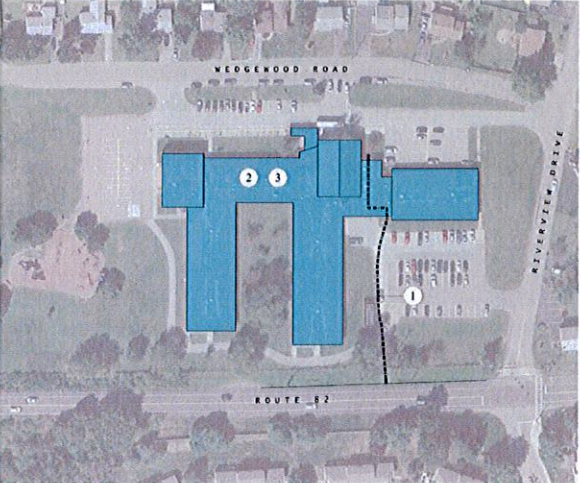

Summer 2014

- No Work

School Year 2014-2015

1. Convert to Gas Heating Fuel
2. Security Improvements
3. Upgrade Emergency Lighting

Summer 2015

- No Work

2013 District Wide Renovations Progress Report

Wappingers Central School District

RHINEBECK ARCHITECTURE & PLANNING PC

April 3, 2014

8

Fishkill Elementary School

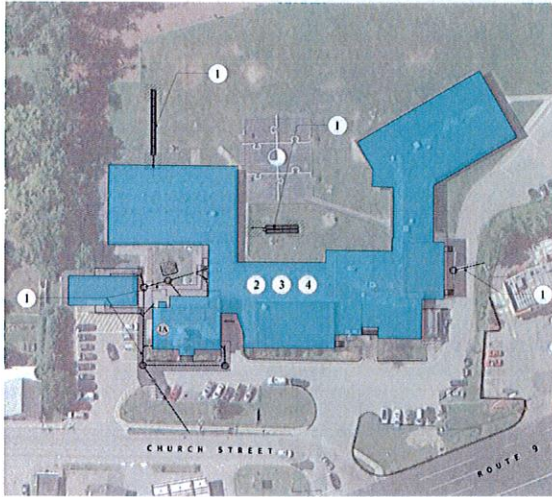

Scope and Schedule

Summer 2014

- 1. Storm Drainage Repairs

School Year 2014-2015

- 2. Security Improvements
- 3. Upgrade Emergency Lighting

Summer 2015

- 4. Replace Windows

Completed Work

- Convert to Gas Heating Fuel

2013 District Wide Renovations Progress Report

Wappingers Central School District

RHINEBECK ARCHITECTURE & PLANNING PC

April 3, 2014

9

Fishkill Plains Elementary School

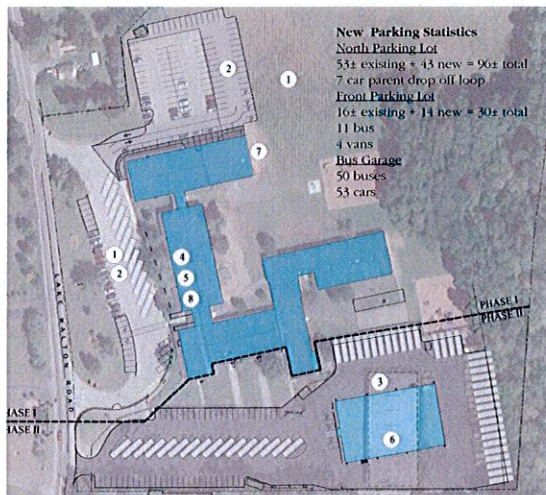

New Parking Statistics
 North Parking Lot
 53± existing + 43 new = 96± total
 7 car parent drop off loop
 Front Parking Lot
 16± existing + 14 new = 30± total
 11 bus
 4 vans
 Bus Garage
 50 buses
 53 cars

Scope and Schedule

Summer 2014

- 1. Drainage Improvements
- 2. Parking Improvements
- 3. Remove Existing Bus Garage
- 7. Masonry Repairs at Gym

School Year 2014-2015

- 4. Security Improvements
- 5. Upgrade Emergency Lighting
- 6. New Transportation Facility

Summer 2015

- 8. Replace Windows

2013 District Wide Renovations Progress Report

Wappingers Central School District

RHINEBECK ARCHITECTURE & PLANNING PC

April 3, 2014

10

Transportation Facility

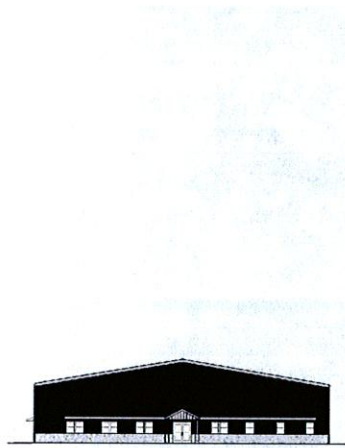

View from the Street

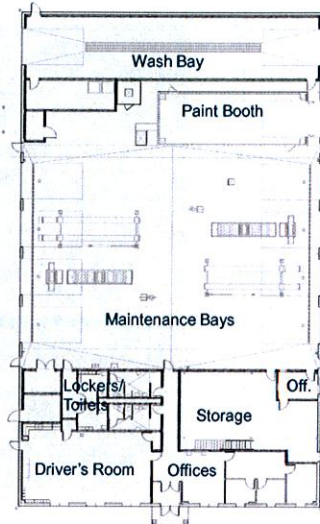

2013 District Wide Renovations Progress Report

Wappingers Central School District

RHINEBECK ARCHITECTURE & PLANNING PC

April 3, 2014

11

Gayhead Elementary School

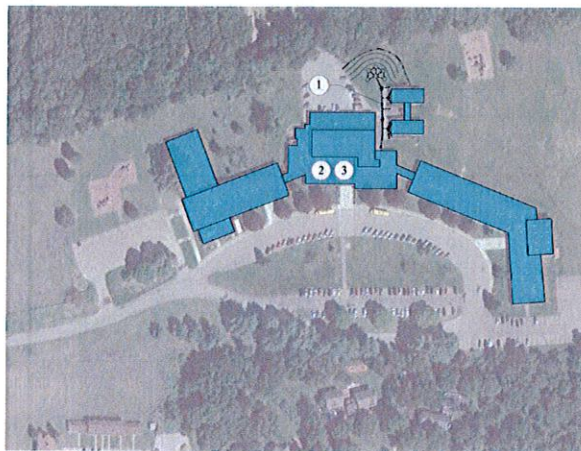

Scope and Schedule

Summer 2014

1. Storm Drainage Repairs

School Year 2014-2015

2. Security Improvements
3. Upgrade Emergency Lighting

Summer 2015

- No Work

Completed Work

- Convert to Gas Heating Fuel
- Sanitary Sewer Connection

2013 District Wide Renovations Progress Report

Wappingers Central School District

RHINEBECK ARCHITECTURE & PLANNING PC

April 3, 2014

12

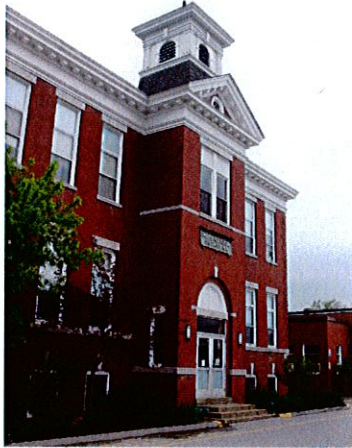

Security Project Cabling Schedule

SCHOOL	TIME FRAME
Ketcham HS	May 1, 2014 - August 1, 2014
John Jay HS	August 1, 2014 - November 1, 2014
Van Wyck HS	November 1, 2014 - December 15, 2014
Wappingers Jr HS	December 15, 2014 - February 15, 2015
Myers Corners ES	February 15, 2015 - April 1, 2015
Gayhead ES	April 1, 2015 to May 15, 2015
Brinckerhoff ES	May 15, 2015 - June 15, 2015
Evans ES	June 15, 2015 - July 15, 2015
Fishkill ES	July 15, 2015 - August 15, 2015
Fishkill Plains ES	August 15, 2015 - September 15, 2015
Kinry Road ES	September 15, 2015 - October 15, 2015
Oak Grove ES	October 15, 2015 - November 15, 2015
Sheafe Road ES	November 15, 2015 - December 15, 2015
Vassar Road ES	December 15, 2015 - January 15, 2016

Time Frame is Preliminary and subject to change as Project proceeds.

2013 District Wide Renovations Progress Report

Wappingers Central School District
RHINEBECK ARCHITECTURE & PLANNING PC

April 3, 2014

19



Next Steps

- **Obtain NYSED Approval for Phase 1**
- **Bid Phase 1 Projects**
- **Phase 2 Projects expected to be reviewed by NYSED in July/August 2014**
- **Questions or Comments?**

2013 District Wide Renovations Progress Report

Wappingers Central School District
RHINEBECK ARCHITECTURE & PLANNING PC

April 3, 2014

20